

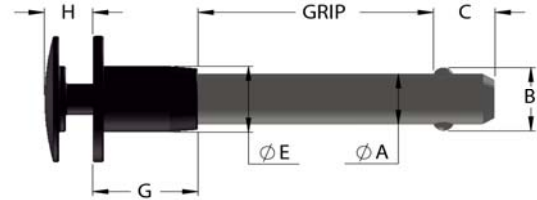

## Sky-Loc™ Domed Button Handle With Custom Laser Engraving!



### Typical Dimensions\*

Nom. Dia. <sup>‡</sup>	A (Dia.)		$\alpha_B$ (+/- .005)	C (+.000/- .030)	D <small>Can be independent of F dim</small>	E	F	G	H	Calculated double-shear strength (lbs)			Min tensile load (2 balls) <sup>Δ</sup>		
	Max	Min								17-4 SS	4130	304 SS	17-4 SS	4130	304 SS
<b>3/16</b>	0.1885	0.1870	0.220	0.260	0.750	0.400	0.750	0.760	0.125	5,150	4,600	1,500	200	200	150
<b>1/4</b>	0.2485	0.2470	0.289	0.290	0.750	0.400	0.750	0.760	0.125	9,200	8,200	2,200	230	230	180
<b>5/16</b>	0.3110	0.3095	0.375	0.330	0.750	0.430	0.750	0.800	0.125	14,400	12,800	3,500	510	510	400
<b>3/8</b>	0.3735	0.3720	0.440	0.365	0.875	0.530	0.875	0.875	0.160	20,600	18,400	4,500	575	575	450
<b>1/2</b>	0.4985	0.4970	0.594	0.460	1.000	0.650	1.000	0.940	0.240	36,800	32,800	11,500	1,160	1,160	900
<b>5/8</b>	0.6235	0.6220	0.750	0.580	1.250	0.860	1.250	1.245	0.240	57,500	51,200	20,000	2,070	2,070	1,500
<b>3/4</b>	0.7485	0.7470	0.887	0.670	1.850	1.000	1.850	1.410	0.310	82,500	73,600	23,000	2,950	2,950	2,200
<b>1</b>	0.9985	0.9970	1.219	0.890	2.200	1.300	2.200	1.880	0.310	147,000	131,000	35,000	5,480	5,480	4,100

**Notes:**

Dimensions in Inches

Grip length +0.020, -0.000. Custom tolerances available.

<sup>‡</sup> Pins can be any diameter 3/16" and up, including metric

<sup>Δ</sup>B Dimension is measured over the balls

<sup>Δ</sup> Add 30% for 4-ball pins

**\*Virtually any dimension can be tailored for your application.**

**Your custom logo can be laser-engraved on the domed button!**



Big Sky Precision, Inc.  
 PO Box 470 (mailing)  
 301 N. Railroad Avenue (shipping)  
 Manhattan, Montana 59741  
 (406) 284-3955  
 Fax: 284-3956  
 Paul's Cell: 539-1599  
 Toll Free: (888) 213-1492

[www.bigskyprecision.com](http://www.bigskyprecision.com)