

DOMED BUTTON HANDLE

WITH CUSTOM LASER ENGRAVING*

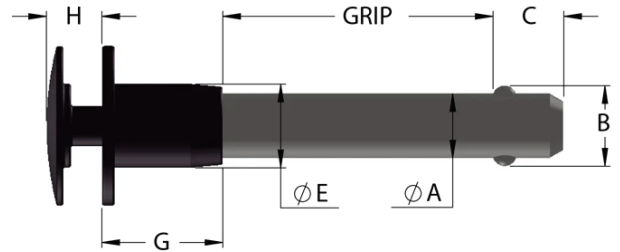

TYPICAL DIMENSIONS*

Nom. Dia. †	A (Dia.)		QB (+/- .005)	C (+.000/- .030)	D <small>Can be independent of F dim</small>	E	F	G	H	Calculated double-shear strength (lbs)		Min tensile load (2 balls) ^Δ	
	Max	Min								17-4 SS	316 SS	17-4 SS	316 SS
3/16	0.1885	0.1870	0.220	0.260	0.750	0.400	0.750	0.760	0.125	5,150	1,500	200	150
1/4	0.2485	0.2470	0.289	0.290	0.750	0.400	0.750	0.760	0.125	9,200	2,200	230	180
5/16	0.3110	0.3095	0.375	0.330	0.750	0.430	0.750	0.800	0.125	14,400	3,500	510	400
3/8	0.3735	0.3720	0.440	0.365	0.875	0.530	0.875	0.875	0.160	20,600	4,500	575	450
1/2	0.4985	0.4970	0.594	0.460	1.000	0.650	1.000	0.940	0.240	36,800	11,500	1,160	900
5/8	0.6235	0.6220	0.750	0.580	1.250	0.860	1.250	1.245	0.240	57,500	20,000	2,070	1,500
3/4	0.7485	0.7470	0.887	0.670	1.850	1.000	1.850	1.410	0.310	82,500	23,000	2,950	2,200
1	0.9985	0.9970	1.219	0.890	2.200	1.300	2.200	1.880	0.310	147,000	35,000	5,480	4,100

*VIRTUALLY ANY DIMENSION CAN BE TAILORED FOR YOUR APPLICATION.

*YOUR CUSTOM LOGO CAN BE LASER-ENGRAVED ON THE DOMED BUTTON!

NOTES

Dimensions in Inches

Grip length +0.020, -0.000. Custom tolerances available.

† Pins can be any diameter 3/16" and up, including metric

QB Dimension is measured over the balls

Δ Add 30% for 4-ball pins