

# PHENDER PRO™ QUICK-RELEASE FENDER RECEIVER

Installation Instructions | Estimated Installation Time: 1 Hour

Locator Disk - Included

## RECOMMENDED TOOLS

Marine Grade Silicone	3/8" Allen Wrench	New 1" Drill Bit (Spade Bit, Hole Saw or Multi-Tooth Forstner Bit)
Loctite (Blue)	Painter Tape	
Dust Rag	Pencil	1/2" or 3/8" Phender Pro Install Tool

### 1. Figure out where they will go. Consider the following factors:

- Each fender should be in the right location to fend off the boat.
- Use the Locator Disk to insure the hole will be drilled in a flat area. (See Diagram A).
- Check behind where the hole will be drilled for structural pieces, cables, etc.
- Put the receivers in the same spot on each side of the boat.

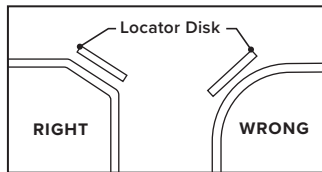

Diagram A

### 2. Drill the holes.

- Using the Locator Disk, mark dead center of the receiver with a pencil.

1/2" Receiver = 1" Hole

3/8" Receiver = 3/4" Hole

- Center punch each hole so the drill won't wander (a small nail can substitute for a center punch.) Drill the hole from the outside towards the inside. Be sure to stop about a third of the way through. Use the hole in the center to drill from the inside just enough to score the fiberglass. Always finish drilling from the outside. This will minimize the risk of chipping the gel-coat.

*Note: If you are not able to drill from the inside because of access problems, drill from the outside only.*

### 3. Install Retrofit receiver.

- Clean inside and outside surfaces.

- Screw install tool into brass nut plate.

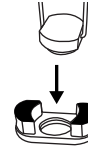

- Remove protective film from adhesive tape.



- Pivot nut plate, insert in hole, pivot back and pull several times to adhere tape on back side of fiberglass.

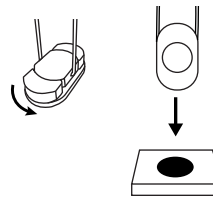

- Unscrew install tool.

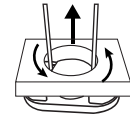

- Apply marine grade silicone to underside of receiver head.

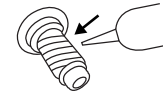

- Apply Loctite to receiver threads, screw into brass nut plate and tighten with allen wrench.

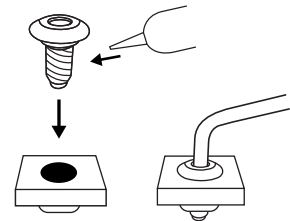

 **BIG SKY**  
PRECISION

 **Phender**  
PRO

MADE IN THE USA • FULL LIFETIME WARRANTY